



## EMI + Standard Outdoor Filter Fan FF 01821 Series

		Standard Version	EMI Version
Part No.	(for 230V, 50Hz)	01821.0-00	01821.1-00
Part No.	(for 120V, 60Hz)	01821.0-02	01821.1-02
Filter mat:	Fine grade	360 g/m <sup>2</sup> , filtering degree 98% particle Ø > 10 µm, F5 (EN 779)	
Air flow			
free blowing		11.8 cfm	
Current consumption	230V	100 mA	
	120V	180 mA	
Power consumption	230V	15W	
	120V	15W	
Average noise level at 3 ft (DIN EN ISO 9614-2)		40 dB (A)	
Mounting depth		2.3" (58 mm)	
Enclosure cut-out		4.9" x 4.9" (125 x 125mm +0.4)	
Weight		approx. 2.6 lbs (1.2 kg)	
Protection type		IP 55	

## EXHAUST FILTER EF 11821 Series

		Standard Version	EMI Version
Part No.		11821.0-00	11821.1-00
Filter mat:	Fine grade	360 g/m <sup>2</sup> , filtering degree 98% particle Ø > 10 µm, F5 (EN 779)	
Mounting depth		0.6" (16 mm)	
Enclosure cut-out		4.9" x 4.9" (125 x 125mm +0.4)	
Weight		approx. 2.1 lbs (0.95 kg)	
Protection type		IP 55	

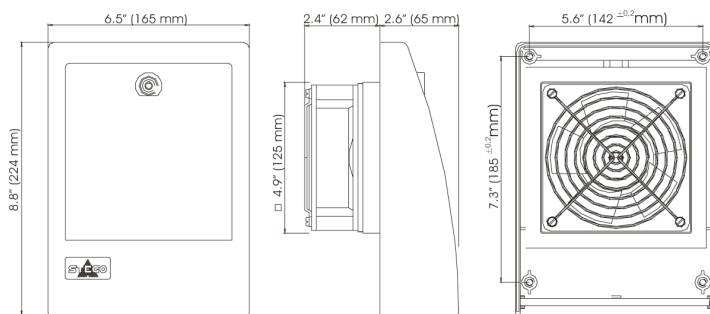

Filter fan

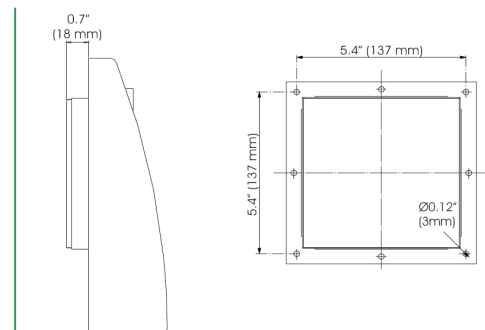

Exhaust filter

Mounting frame

### OTHER TECHNICAL DATA:

**Axial fan:** Ball bearing, aluminum frame, plastic impeller UL94V-0  
Operational life min. 50.000 h at 77°F (RH 65%)  
Ambient temperature -22°F to 158°F.  
2 lead wires 4" long with pressure clamps, type AWG14 max.  
DC Axial fan in 12V, 24V, 48V available on request.

### Filter material:

Synthetic fiber with progressive construction, temperature resistant to 212°F, self-extinguishing class F1.  
Moisture resistant to 100% RH.  
Can be cleaned by washing or vacuuming for reuse.  
Replacement filter mats available on request.

**Filter fan & exhaust filter housing:** Plastic ASA, UL94HB  
Color light grey, temperature resistant -31°F to 194°F.

**Mounting frame:** With double sided industrial adhesive tape for affixing to the outside of enclosure. Certain operating conditions may make the additional use of screws necessary.

The hood is fixed permanently to the enclosure from the inside using screws.  
Filter mats can be easily changed from outside the enclosure through the lockable door in the hood.

ITSENCLOSURES a division of Integration Technology Systems Inc.

271 Westech Drive Mt. Pleasant, PA 15666

ph: 800.423.9911 fax: 724.696.3333 web: [www.itsenclosures.com](http://www.itsenclosures.com) E-mail: [info@itsenclosures.com](mailto:info@itsenclosures.com)